

VEF

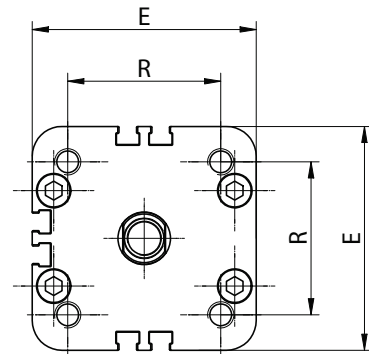
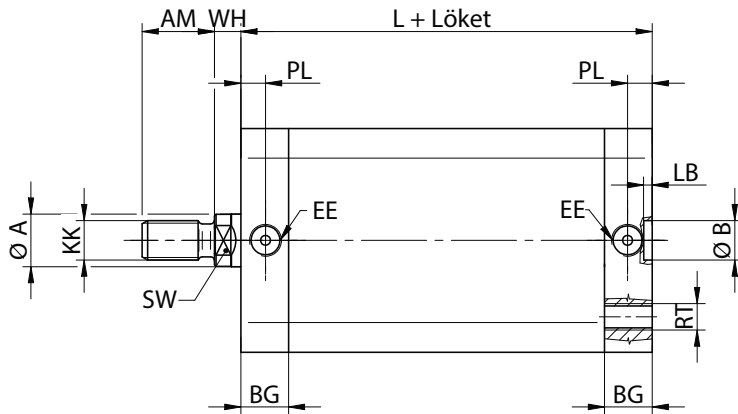

VIF

Ø [mm]	A	B	E	L	R	AM	BG	EE	KK	LB	PL	RT	SW	WH
Ø32	12	9	49	44	32,5	12 (15)*	14,5	G1/8"	M8	2,1 (3)*	7,5	M6	10	7 (6,5)*
Ø40	12	9	55 (54,5)*	45	38	12 (15)*	15	G1/8"	M8	2,1 (3)*	7,5 (8)*	M6	10	7
Ø50	16	12	68 (65,5)*	45	46,5	16 (17)*	14,5	G1/8"	M10	2,6 (4)*	7,5 (8)*	M8	13	8
Ø63	16	12	78,5 (77)*	49	56,5	16 (17)*	14	G1/8"	M10	2,6 (4)*	7,5	M8	13	8,5 (8)*
Ø80	20	12	98 (95,5)*	54	72	20	15,5	G1/8"	M12	2,6 (4)*	7,5 (8)*	M10	17	10 (9)*
Ø100	25	12	120 (113,5)*	67	89	20 (22)*	20	G1/8"	M12	2,6 (4)*	7,5 (8)*	M10	22	10

*VENK, VENH, VEFK, VEFH, VENVK, VENVH, VEFVK, VEFVH, VINK, VINV, VIFK, VIFV, VBNK, VBNV, VBFK, VBFV, VINTK, VINTV hengerek esetében